

# Tolerance Manager Training

Tolerance Manager\_Training.zip



# Tolerance Manager - Overview

## Main Functions

- Batch Insert Tolerance to Selected Dimensions
- Batch Remove Tolerance to Selected Dimensions
- Continuous operation with Insert/Remove Tolerance mode enabled

## Benefits

- Batch insertion without individual editing for tolerance insertion
- Reduce repetitive work by removing tolerances written on existing dimensions
- Reduce design change time by batch modifying tolerances of dimensions

## Course Objective: Follow the instructions through course and learn how to use Tolerance Manager

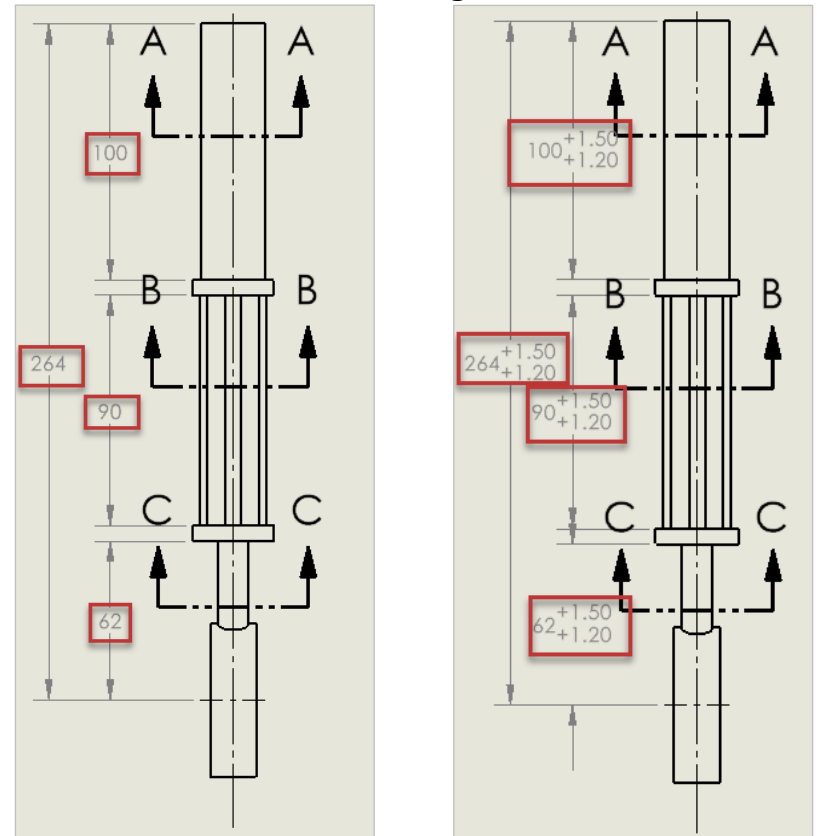
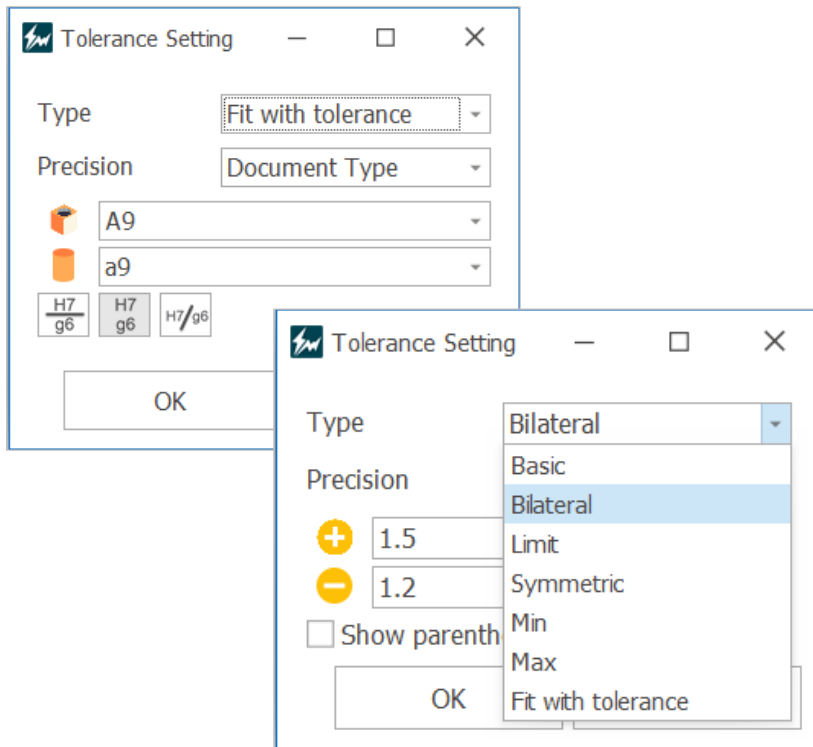

## Tolerance Manager - Tolerance Setting

Work on the part with the red circle (1) following instructions by yourself.  
The part with the black square (1) is an additional explanation or a reference.

1 Execute **Broken&Sections\_&.SLDDRW** among training files.

2 Click **[SpeedWorks]**tab - **[Tolerance Setting]** button.

3 Select **[Bilateral]** in **[Type]**.

4 Enter '1.5' in **[Plus Value]**.

5 Enter '1.2' in **[Minus Value]**.

6 Click **[OK]** button.

1 This screen is the tolerance setting screen.

2 **[Type]**: The tolerance type kind. Users can select the type of tolerance to use when inserting tolerances.

3 **[Precision]**: Users can specify the precision of the tolerance to insert.

4 Depending on the selected tolerance type, the tolerance value entry items are different.

5 **[Show Parentheses]**: When inserting a tolerance, it is inserted by adding parentheses to the tolerance.

※ You can download example files at Support page in SpeedWorks Homepage(<http://speedworks.info>).

Name	Date modified	Type	Size
Broken&Sections_&.SLDDRW	2022-06-28 오후 1:31	SOLIDWORKS Dr...	216KB
Broken&Sections_&.SLDPRT	2016-10-19 오후 1:58	SOLIDWORKS Par...	136KB

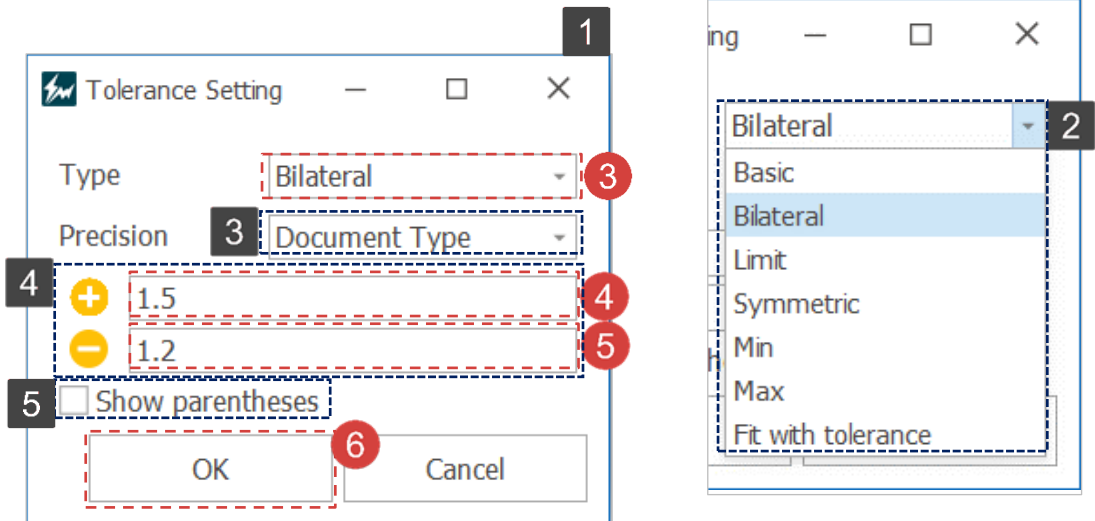
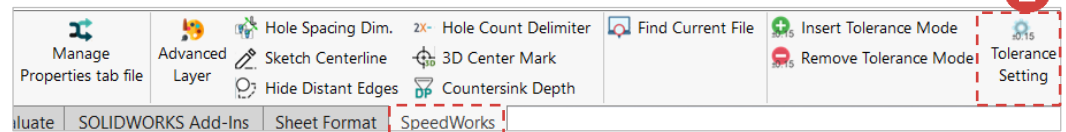

## Tolerance Manager - Insert Tolerance

Work on the part with the red circle (1) following instructions by yourself.  
The part with the black square (1) is an additional explanation or a reference.

- 1 Click **[Insert Tolerance Mode]** button.
- 2 Select  $\varnothing 25$  dimension.
- 3 Select  $\varnothing 60$ ,  $\varnothing 32$ , 18 dimensions by dragging.

- 1 **[Tolerance Insertion Mode]** is a toggle-type button.  
When a dimension is selected with the corresponding tool active, inserting tolerance. If users select the activated **[Tolerance Insertion Mode]** tool again, it becomes inactive.
- 2 It is a picture of the dimension with the tolerance inserted.

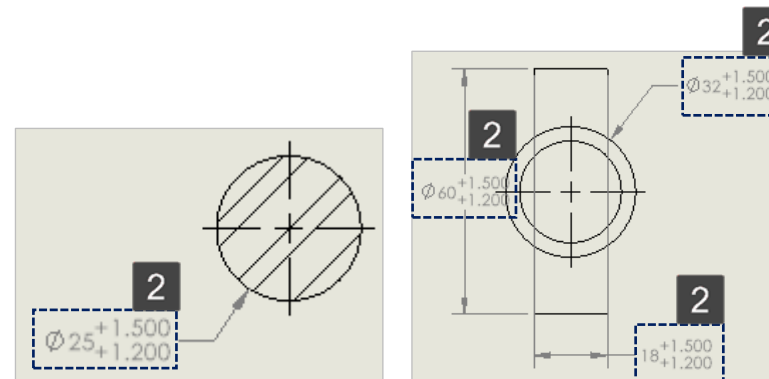
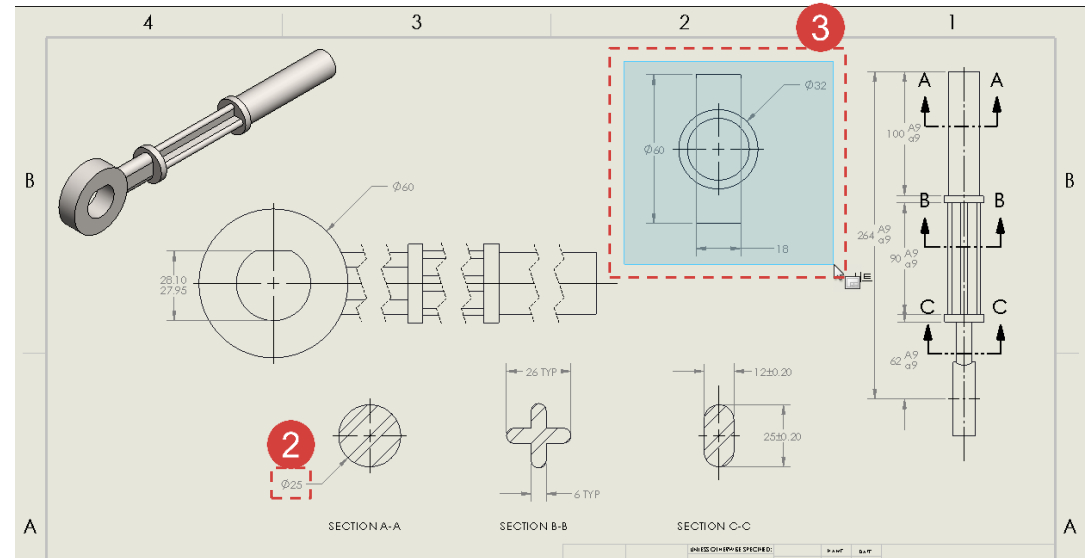
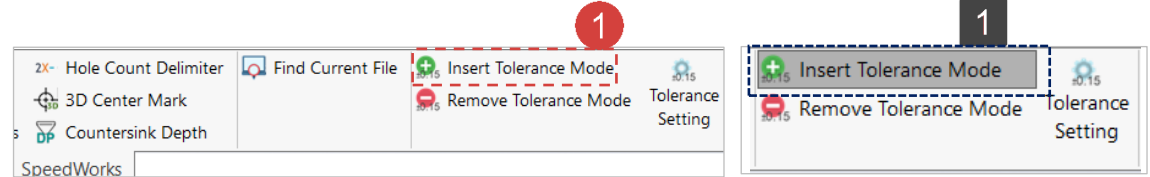

## Tolerance Manager - Edit Tolerance

Work on the part with the red circle (1) following instructions by yourself.  
The part with the black square (1) is an additional explanation or a reference.

- 1 Select **[Tolerance Setting]** button.
- 2 Select '**Symmetric**' in **[Type]**.
- 3 Select '**.12**' in **[Precision]**.
- 4 Enter '**0.5**' in Plus Value.
- 5 Click **[OK]** button.
- 6 Select **28.10/27.95** dimension in drawing.

- 1 If **[Insert Tolerance Mode]** is deactivated, it should be activated by click.
- 2 It is a picture of the dimension with the tolerance edited.

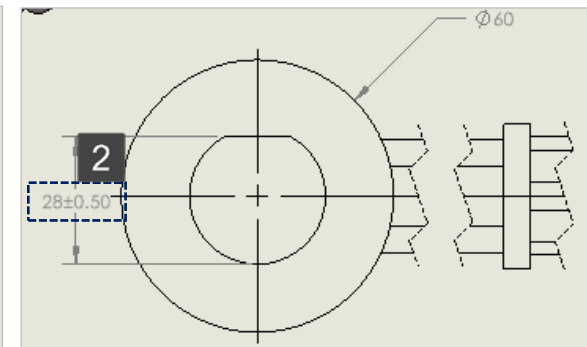
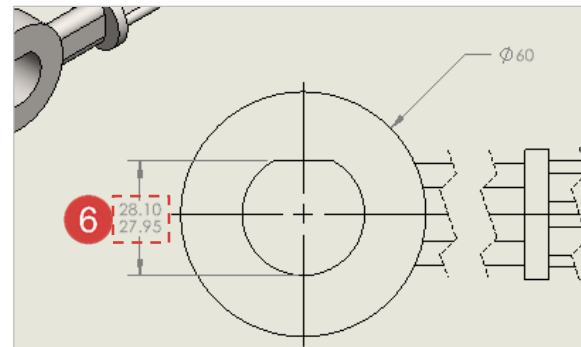
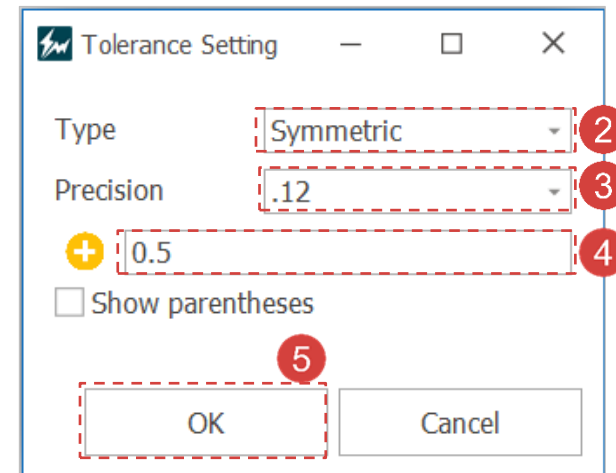
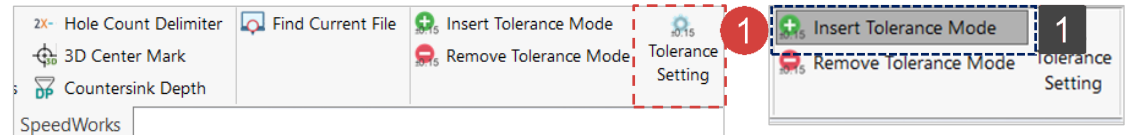

## Tolerance Manager - Remove Tolerance

Work on the part with the red circle (1) following instructions by yourself.  
The part with the black square (1) is an additional explanation or a reference.

- 1 Click **[Remove Tolerance Mode]** button.
- 2 Select **264 A9/a9** dimension.
- 3 Click **[Yes]** button.
- 4 Select **12±0.20, 25±0.20** multiple dimensions by dragging.
- 5 Click **[Yes]** button.

1 **[Tolerance Remove Mode]** is a toggle-type button. When users select a dimension with the corresponding tool active, removing tolerance. If users select the activated **[Tolerance Remove Mode]** tool again, it becomes inactive.

2 If **[Tolerance Remove Mode]** is selected while **[Inserting Tolerance Mode]** is enabled, **[Insert Tolerance Mode]** is deactivated. The reverse works the same.

3 Before removing the tolerance, users can check the number of dimensions to be removed.

4 Users can prevent the window from appearing in the future by checking **[Don't show this message again]**.

5 It is a picture of the dimension with the tolerance inserted.

